

CL400 Height adjustable TV cart

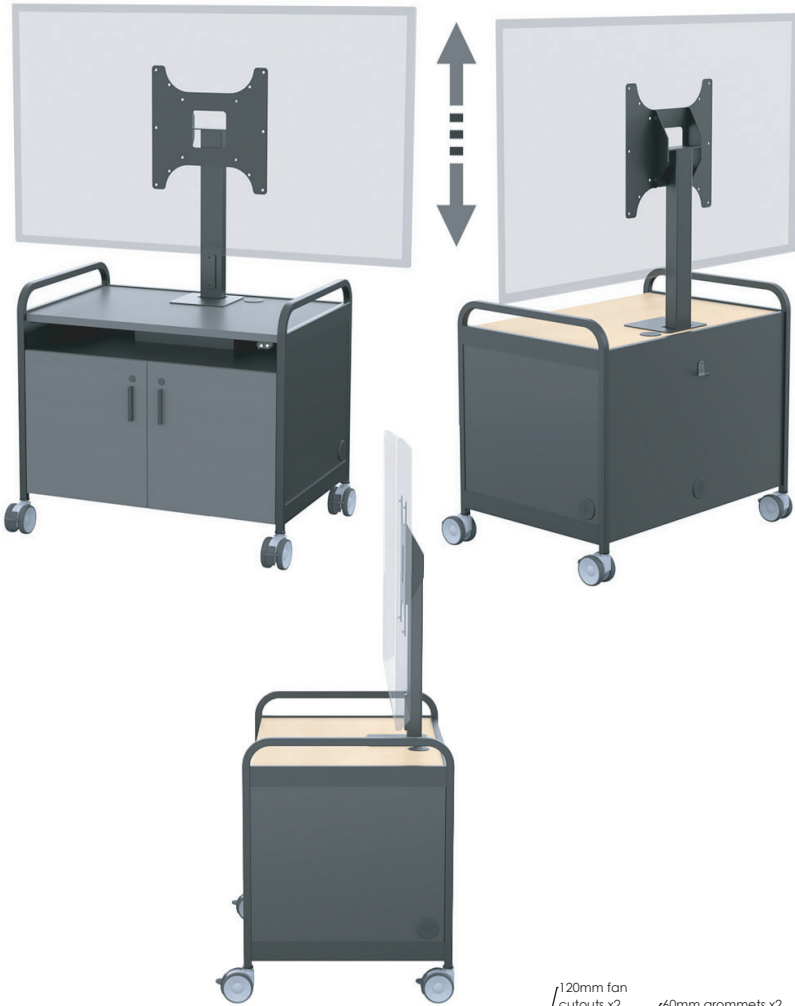

The CL400 adjustable height TV cart for single 32-75" Display. It features a pushbutton electric TV lift for higher display visibility. Metal corners and handles for durability. Tente™ Dual wheel locking Casters for smooth ride. Large locking interior can accommodate a PC and an 8RU drop in rack. Ideal for classroom and training environments. Offered in several finishes.

Standard Features

- Holds single, 32-75" display up to VESA 400x400mm
- Linak™ powered push button electric TV height adjust of 19.68"
- Large lockable interior storage (8RU Drop in rack ready)
- Shelf for speakers or soundbar.
- Durable design with metal corners and handles.
- Available in many finishes.

Specifications

Model: TP500
 Width: 39.54" Depth: 29"
 Height: 60-80"
 Weight Capacity: 80 lbs (36 kg) display total

Options

- PB Six outlet power bar with 10 ft. cord
- FAN Can accommodate up to two 120mm fans
- BKT-SBB2 Sound bar bracket
- CBB-TV Under TV camera bracket (26" - 80" TV's)
- TVCB Upper camera Bracket 32-55" TV
- TVCB-XL Upper camera Bracket 56-90" TV
- CUB3 Power Panel 1x AC 1x USB+ Passthrough
- CUB22 Power Panel 2x AC 2x USB
- CUSTOM CUTOUT Cutouts for electronics or other items specified by the customer

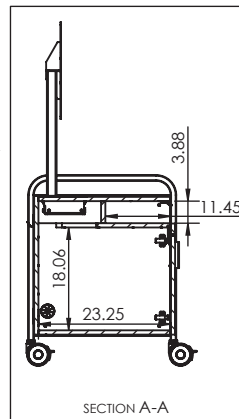
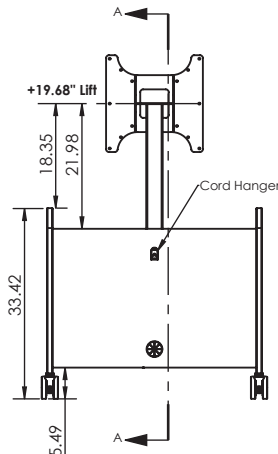
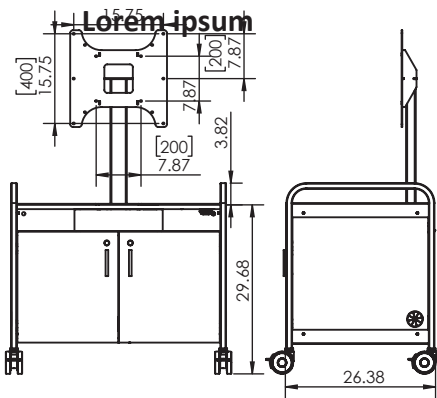
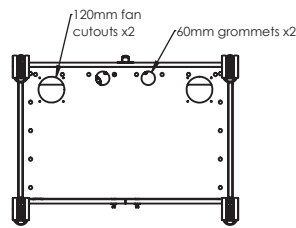
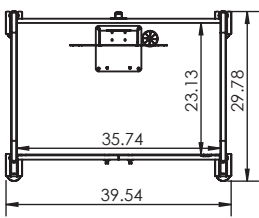

Finishes Shown in STL and MPL

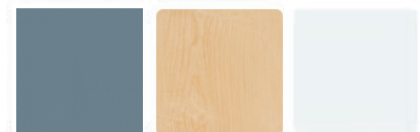

Other finishes are available. Check website.

The information contained in this drawing is the sole property of Audio Visual Furniture International. Any reproduction in part or as a whole without the written permission of Audio Visual Furniture International is prohibited. We can build or modify stock configurations to suit customer specifications. Please contact us to discuss how this service can help meet your needs. Some quantity restrictions may apply. Specification subject to change without notice. Computers, cameras, monitors, etc. are shown to illustrate product usage and are not included unless otherwise noted.